



## TRASCO 'GR' CURVED JAW COUPLING

### CURVED JAW

The TRASCO® coupling is a flexible coupling with curved jaw design that has the highest ratio transmitted power/dimension in its category. The construction allows safe power transmission between driver and driven shafts, absorbing impact loads and torsional vibrations. Hubs are stocked in cast iron and aluminium, but also available in steel on request. It is available with both pilot bore, standard hub and long hub series, taper bore and Flange mount. A wide range of elements including Shore hardness of 80A (Blue), 92A (White/Yellow) & 98A (Red) are available across the range. Elements are rated for normal operating temperatures up to 90 °C. TRASCO couplings are available to suit standard British taper bore.

### PERFORMANCE DATA



Part No.	Max Bore (A Type)	Max Bore (B Type)	Power at 100 RPM kW	Nominal Torque (Nm)			Normal Maximum Speed (RPM)
				Shore 80 A	Shore 92 A	Shore 98 A	
14	-	14	0.079	4.0	7.5	12.5	19000
19/24	-	24	0.120	5.0	11.5	17.0	14000
24/32	24	32	0.419	17.0	40.0	60.0	10600
28/38	28	38	1.204	46.0	115.0	160.0	8500
38/45	38	45	2.356	93.0	225.0	325.0	7100
42/55	42	55	3.246	130.0	310.0	450.0	6000
48/60	48	60	3.770	150.0	360.0	525.0	5600
55/70	55	70	4.503	180.0	430.0	680.0	4750
65/75	65	75	6.597	205.0	630.0	950.0	4250
75/90	75	90	13.089	475.0	1250.0	1950.0	3550
90/100	90	100	31.937	1175.0	3050.0	3600.0	2800
100/110*	115	-	41.466		3960.0	-	2500
110/125*	125	-	50.262		4800.0	-	2240
125/145*	145	-	62.827		6000.0	-	2000

\* White/Yellow element Shore 95 A instead of Shore 92 A  
Power at 100 RPM based on White/Yellow element



TAPER BORE SERIES

For dimensional data  
see page 16



FLANGE SERIES

For dimensional data  
see page 16



# TRASCO 'GR' CURVED JAW COUPLING

## DIMENSIONAL DATA

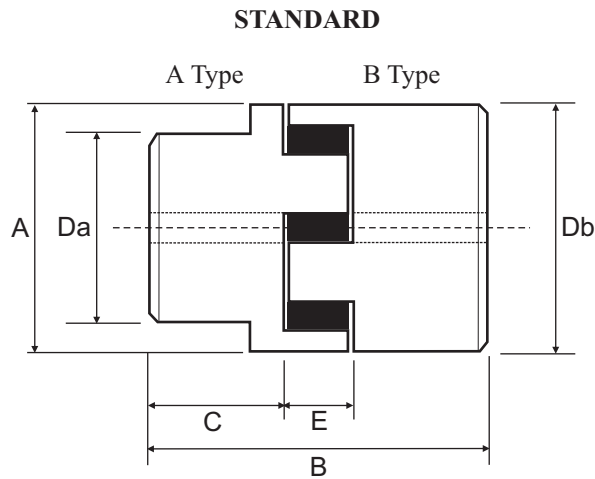

### STANDARD AND LONG SERIES

Part No.	Bore				A	B Std	C Std	C Type A Long	C Type B Long	Da	Db	E
	A Type		B Type									
	Min	Max	Min	Max								
14	-	-	-	14.0	30.0	35.0	11.0	-	-	-	30.0	13.0
19/24	-	-	-	24.0	40.0	66.0	25.0	-	50.0	-	40.0	16.0
24/32	-	24.0	-	32.0	55.0	78.0	30.0	50.0	60.0	40.0	55.0	18.0
28/38	-	28.0	-	38.0	65.0	90.0	35.0	60.0	80.0	48.0	65.0	20.0
38/45	-	38.0	-	45.0	80.0	114.0	45.0	80.0	110.0	66.0	80.0	24.0
42/55	-	42.0	-	55.0	95.0	126.0	50.0	110.0	110.0	75.0	95.0	26.0
48/60	-	48.0	45.0	60.0	105.0	140.0	56.0	110.0	140.0	85.0	105.0	28.0
55/70	-	55.0	47.0	70.0	120.0	160.0	65.0	110.0	140.0	98.0	120.0	30.0
65/75	-	65.0	55.0	75.0	135.0	185.0	75.0	140.0	140.0	115.0	135.0	35.0
75/90	-	75.0	50.0	90.0	160.0	210.0	85.0	140.0	170.0	135.0	160.0	40.0
90/100*	89.0	90.0	79.0	100.0	200.0	245.0	100.0	170.0	210.0	160.0	180.0	45.0
100/110	42.0	115.0	-	-	225.0	270.0	110.0	-	-	180.0	-	50.0
110/125	55.0	125.0	-	-	225.0	295.0	120.0	-	-	200.0	-	55.0
125/145	65.0	145.0	-	-	290.0	340.0	140.0	-	-	230.0	-	60.0

\* Stepped B Hub



# TRASCO 'GR' CURVED JAW COUPLING

## DIMENSIONAL DATA

### TAPER BORE SERIES

Part No.	Bore		Taper Bush Size	A	B	C	D	E
	Min	Max						
28/38	9.5	28.0	1108	65.0	66.0	23.0	65.0	20.0
38/45	9.5	28.0	1108	80.0	70.0	23.0	78.0	24.0
42/55	12.0	42.0	1610	95.0	78.0	26.0	94.0	26.0
48/60	12.0	42.0	1615	105.0	106.0	39.0	104.0	28.0
55/70	16.0	50.0	2012	120.0	96.0	33.0	118.0	30.0
65/75	16.0	50.0	2012	135.0	101.0	33.0	133.0	35.0
75/90	19.0	60.0	2517	160.0	130.0	45.0	158.0	40.0
90/100	35.0	90.0	3535	200.0	223.0	89.0	180.0	45.0

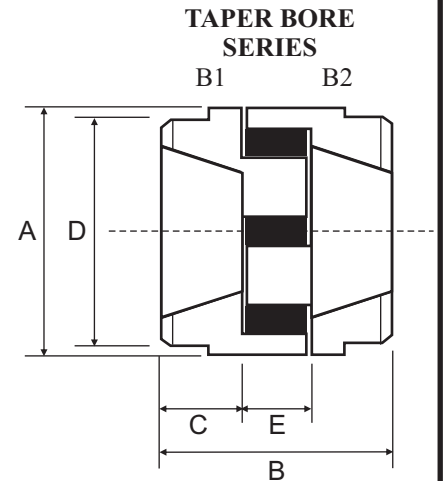

## DIMENSIONAL DATA

### FLANGE SERIES

Part No.	Bore		A	B	C	E	P.C.D.	Bolts / Hole
	Min	Max						
19	6.0	19.0	65.0	49.0	8.0	16.0	50.0	5 x 4.5
24	8.0	24.0	80.0	56.0	8.0	18.0	65.0	5 x 4.5
28	10.0	28.0	100.0	65.0	10.0	20.0	80.0	6 x 6.5
38	12.0	38.0	115.0	79.0	10.0	24.0	95.0	6 x 6.5
42	14.0	42.0	140.0	88.0	12.0	26.0	115.0	6 x 9.0
48	15.0	48.0	150.0	96.0	12.0	28.0	125.0	8 x 9.0
55	20.0	55.0	175.0	111.0	16.0	30.0	145.0	8 x 11.0
65	22.0	65.0	190.0	126.0	16.0	35.0	160.0	10 x 11.0
75	30.0	75.0	215.0	144.0	19.0	40.0	185.0	10 x 14.0
90	40.0	90.0	260.0	165.0	20.0	45.0	225.0	12 x 14.0

