



BAUMANN COUPLING

BAUMANN

The principal feature of the Baumann Flex Coupling is the multi-layer and multi-coil spring assembly, which is brazed firmly to the end pieces designed either as collars, flanges or hubs. The coupling serves primarily to take up inaccuracies of alignment between two rotating shafts; it provides torsional flexibility in the coupling of such shafts and damps vibration.

Its effectiveness is largely independent of the direction of rotation, as in one direction the outer and middle counter-coiled spring layers work together to transmit the load, while in the other direction, the middle and inner layers come into operation.

Coupling Type MM and MF are also available with clamping style hubs in sizes 6 through to 28.

PERFORMANCE DATA

Part No.	Max Bore & Key	Max Bore No Key	Power at 100 RPM kW	Nominal Torque (Nm)	Normal Maximum Speed (RPM)
6	6.0	10.0	0.026	2.5	20000
8	8.0	12.0	0.052	5.0	15000
12	12.0	15.0	0.105	10.0	12000
14	14.0	19.0	0.105	10.0	10000
16	16.0	20.0	0.209	20.0	9000
19	19.0	25.0	0.209	20.0	8000
20	20.0	27.0	0.419	40.0	7000
24	24.0	31.0	0.419	40.0	7000
25	25.0	34.0	0.942	90.0	6000
28	28.0	35.0	0.942	90.0	6000
30	30.0	40.0	1.571	150.0	5000
35	35.0	45.0	2.304	220.0	4500
40	40.0	50.0	3.141	300.0	3000

Maximum torque can only be achieved with correctly aligned shafts.

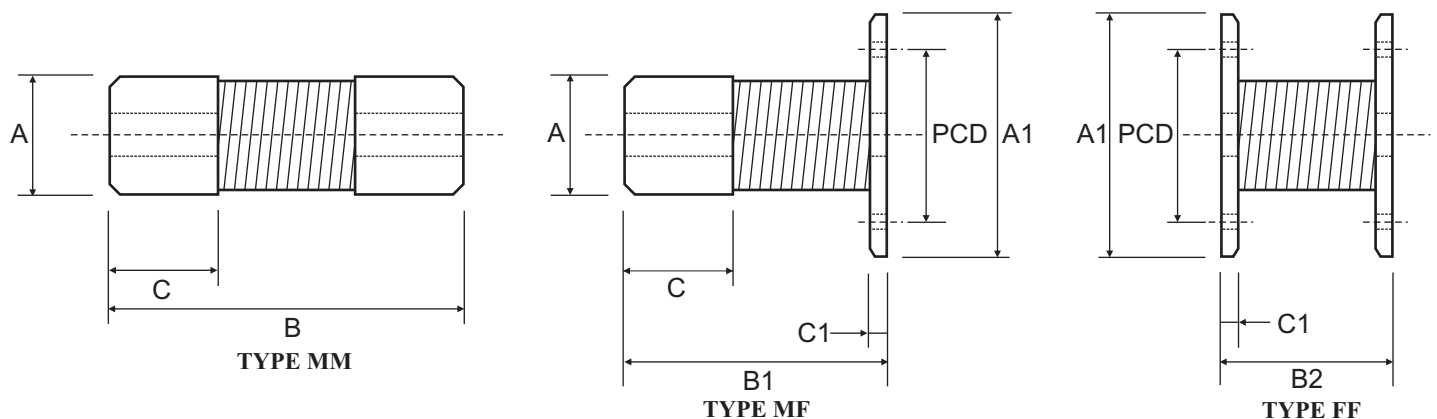
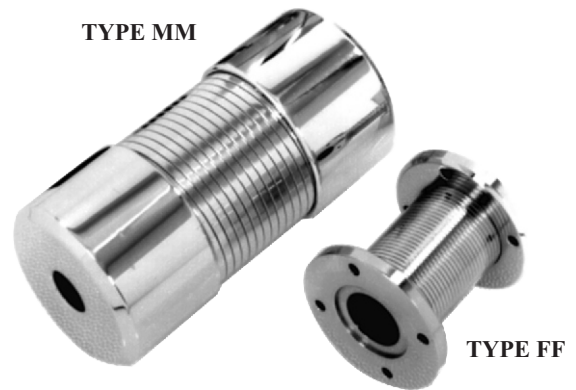

Other types available, contact Naismith Engineering.



BAUMANN COUPLING

DIMENSIONAL DATA

Part No.	Bore			A	A1	Length Code	B	B1	B2	C	C1	PCD
	Min	Max With Key	Max No Key									
6	2.5	6.0	10.0	17.0	32.0	K	25.0	20.0	15.0	8.0	4.0	24.0
						L	30.0	25.0	20.0			
						D	35.0	30.0	25.0			
8	3.5	8.0	12.0	21.0	42.0	K	35.0	30.0	25.0	10.0	6.0	30.0
						L	45.0	40.0	35.0			
						D	50.0	45.0	40.0			
12	5.5	12.0	15.0	26.0	48.0	K	50.0	40.0	30.0	15.0	6.0	37.0
						L	60.0	50.0	40.0			
						D	70.0	60.0	50.0			
14	5.5	14.0	19.0	30.0	52.0	K	50.0	40.0	30.0	15.0	6.5	40.0
						L	60.0	50.0	40.0			
						D	70.0	60.0	50.0			
16	5.5	16.0	20.0	35.0	58.0	K	65.0	50.0	35.0	20.0	6.5	47.0
						L	80.0	65.0	50.0			
						D	90.0	75.0	60.0			
19	5.5	19.0	25.0	38.0	62.0	K	65.0	50.0	35.0	20.0	7.0	50.0
						L	80.0	65.0	50.0			
						D	90.0	75.0	60.0			
20	5.5	20.0	27.0	45.0	65.0	K	80.0	60.0	40.0	25.0	7.0	52.0
						L	95.0	75.0	55.0			
						D	110.0	90.0	70.0			
24	5.5	24.0	31.0	48.0	70.0	K	80.0	60.0	40.0	25.0	7.0	57.0
						L	95.0	75.0	55.0			
						D	110.0	90.0	70.0			
25	5.5	25.0	34.0	55.0	75.0	K	100.0	75.0	50.0	31.0	8.5	62.0
						L	120.0	95.0	70.0			
						D	140.0	115.0	90.0			
28	5.5	28.0	35.0	55.0	78.0	K	100.0	75.0	50.0	31.0	8.5	65.0
						L	120.0	95.0	70.0			
						D	140.0	115.0	90.0			
30	5.5	30.0	40.0	65.0	90.0	K	125.0	95.0	65.0	37.0	10.0	74.5
						L	150.0	120.0	90.0			
						D	175.0	145.0	115.0			
35	5.5	35.0	45.0	75.0	100.0	K	150.0	115.0	80.0	44.0	13.0	84.0
						L	180.0	145.0	110.0			
						D	210.0	175.0	140.0			
40	21.0	40.0	50.0	80.0	120.0	K	170.0	130.0	90.0	50.0	14.0	101.5
						L	200.0	160.0	120.0			
						D	240.0	200.0	160.0			