

HDP, HDPX, HD - PDX FLUID COUPLINGS

Pulley type HD-P fluid couplings

HD-P fluid couplings are for belt drive and are offered in different executions with and without delayfill chamber. These couplings can be supplied without pulley or with pulley within specified range tabulated below. This provides flexibility for use of pulleys of different specification on the same coupling. Standard fusible plug blow off temperature is 130 degrees C.

Part No. HD-P / HD-PX / HD-PDX	Max Bore Fluid Coupling	Max Kw rating at input speed		Max Speed
		900	1470	
3	42.0	2	10	1800
4	50.0	4	15	1800
5	65.0	7	30	1800
6	65.0	9	40	1800
7	75.0	15	62	1800



DIMENSIONAL DATA

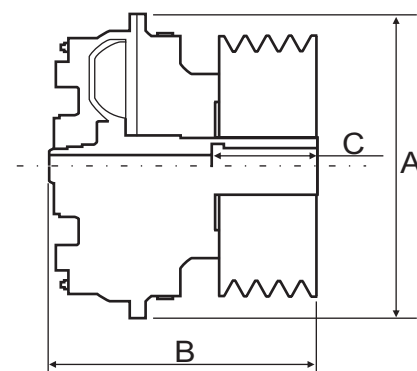

Part No. HD-P / HD-PX / HD-PDX	Max Bore Fluid Coupling	A	B			C	Min Pulley	Max Pulley
			HD-P	HD-PD	HD-PDX			
3	42.0	342.0	289.0	351.0	390.0	110.0	SPA 115mm X 5 SPB120mm X 4 SPC130mm X 3	SPA320mm X 5 SPB320mm x 4 SPC320mm x 3
4	50.0	367.0	294.0	361.0	390.0	110.0	SPA 115mm X 5 SPB120mm X 4 SPC130mm X 3	SPA320mm X 5 SPB320mm x 4 SPC320mm x 3
5	65.0	406.0	356.0	413.0	463.0	142.0	SPA 130mm X 7 SPB135mm X 6 SPC145mm X 4	SPA350mm X 8 SPB350mm x 7 SPC350mm x 5
6	65.0	435.0	395.0	456.0	526.0	142.0	SPA 150mm X 9 SPB160mm X 7 SPC170mm X 5	SPA400mm X 10 SPB400mm x 8 SPC400mm x 6
7	75.0	471.0	405.0	464.0	534.0	142.0	SPA 150mm X 9 SPB160mm X 7 SPC170mm X 5	SPA400mm X 10 SPB400mm x 8 SPC400mm x 6

HD - P = Standard Coupling
 HD - PD = Delay Fill Chamber
 HD - PDX = Extended Delay Fill Chamber